

PARTS BOOK

LUNDELL

RUNNING GEARS

1250 & 1270



MANUFACTURING COMPANY

(INCORPORATED)

CHEROKEE, IOWA

MAIN FRAME

Ref.No.	Part No.	Description	No. Req. 8 Ton	No. Req. 10 Ton	Ref.No.	Part No.	Description	No. Req. 8 Ton	No. Req. 10 Ton
1	5743L1	Front Axle	1		25	X-511	Nut 5/8 N.C. Hex	x	x
2	5744L1	Front Axle	1	1	26	X-705	Lockwasher 5/8	x	x
3	5745L1	Rear Axle	1		27	X-780	Flatwasher 5/8	x	x
4	5746L1	Rear Axle	1	1	28	5752L1	Coil Spring	x	x
5	4040L1	Front Tongue Ass'y	1	1	29	X-236	Capscrew 5/8 x 3 N.C.	x	x
6	4039L1	Rear Tongue Ass'y	1	1	30	5753L1	Nut 7/8 N.F. Hex Jam	2	2
7	4037L1	Reach	1	1	31	5754L1	Grease Fitting	x	x
8	4261L91	Stub Tongue Ass'y	1	1	32	5755L1	Grease Fitting	x	x
9	5747L1	Front L.H. Spindle	1	1	33	5756L1	Capscrew 3/4 x 4 N.C.	1	1
10	5748L1	Front R. H. Spindle	1	1	34	X-708	Lockwasher 3/4	1	1
11	2976L1	Tongue Pin	1	1	35	5764L1	Nut 3/4 N.C. Hex	1	1
12	4115L1	Stub Tongue Pin	1	1	36	5757L1	Nut 5/8 N.F. Hex Slotted	1	1
13	2983L1	Pivot Pin	3	3	37	3465L1	Flatwasher	x	x
14	5749L1	Bolster Stake Front	Opt.	Opt.	38	X-807	Cotter Pin 5/32 x 1 1/2	x	x
15	4034L1	Washer	2	2	39	X-534	Nut 3/4 N.F. Hex Slotted	x	x
16	4264L91	Tie Rod End	2	2	40	X-213	Capscrew 3/8 x 1 N.C. H.T.	x	x
17	4265L91	Tie Rod	2	2	41	5758L1	Thrust washer	2	2
18	4273L1	Reach Pin	2	2					
19	5750L1	Bolster Stake Rear	Opt.	Opt.	42	5759L1	ADJUSTABLE TONGUE		
20	2988L1	Solid Bolster	Opt.	Opt.	43	5760L1	Front Tongue Ass'y	1	1
21	4901L91	Rocking Bolster	Opt.	Opt.	44	X-507	Catch Arm	1	1
22	4902L91	Mounting Pad	Opt.	Opt.	45	X-703	Nut 1/2 N.C. Hex	2	2
23	5765L1	Capscrew 3/8 x 4	x	x	46	X-227	Lockwasher 1/2	2	2
24	X-702	Lockwasher 3/8	x	x	47	5761L1	Capscrew 1/2 x 3 1/2 N.C.	2	2
25	X-503	Nut 3/8	x	x	48	5762L1	Coil Spring	1	1
26	X-771	Flat washer	x	x	49	5763L1	Catch Arm Base	1	1
27	X-807	Cotter Pin 5/32 x 1 1/2	x	x			Rear Tongue Ass'y	1	1

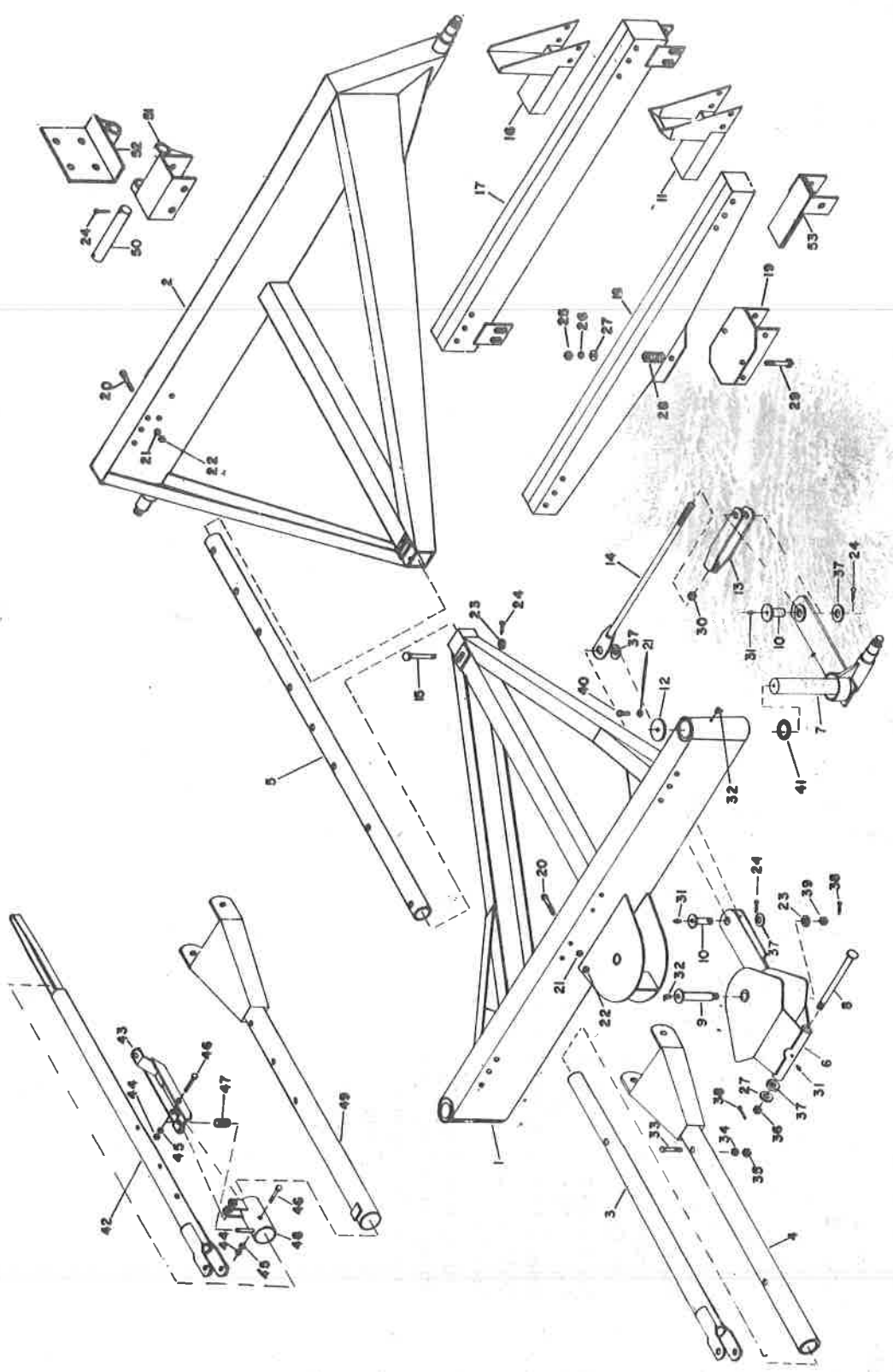

6 BOLT HUB ASS'Y

Ref.No.	Part No.	Description	No. Req.			NATIONAL OR	22870 SKF
			8 Ton	10 Ton	10 Ton		
	581341	Spindle					
1	3044L1	Grease Seal	4	4		204035	
2	3043L1	Inner Peering Cone	4	4		342A	TIMKEN
3	3041L1	Inner Bearing Cup	4	4		332	TIMKEN
4	5770L1	Hub Ass'y - Inc. #'s 4,6 12, & 13	X	X			
5	5771L1	Hub Bolt	24	24			
6	3465L1	Washer	4	4			
7	X-534	Spindle Nut	4	4			
8	3999L1	Hub Cap	4	4			
9	3039L1	Wheel Rim - 14x6 - 6 Bolt	X	X			
10	3038L1	Wheel Rim - 15x6 - 6 Bolt	X	X			
	5767L1	Wheel Rim - 15x8 - 6 Bolt	X	X			
	X-807	Cotter Pin	4	4			
11	X-509	Hub Nut	24	24			
12	3996L1	Outer Bearing Cup	4	4		LM 29710	TIMKEN
13	3995L1	Outer Bearing Cone	4	4			
14	5735L1	Grease Fitting	4	4		LM 29749	TIMKEN
15	5769L1	Hub Ass'y Comp. - Inc. 2, 3, 5, & 14 & 15	X	X			

